

## Technical Characteristics

<b>Material</b>	: Phosphor Bronze
<b>Contact Resistance</b>	: 5 mΩ Max
<b>Insulation Resistance</b>	: 5.10 <sup>5</sup> MΩ at 500V
<b>Withstanding Voltage</b>	: 1100V
<b>Contact Direct Current Rating</b>	: 3A DC
<b>Contact Alternating Current Rating</b>	: 5A AC
<b>Operating Temperature</b>	: -55°C to +150°C
<b>Capacitance between Two Contacts</b>	: 4pF Max
<b>Plating Options</b>	
<b>Tin (T)</b>	: 2.5μ Tin over 1.25μ Nickel
<b>Selective Gold (SG)</b>	: 0.15μ Gold over 1.25μ Nickel
<b>Others Available Upon Request</b>	

**RoHS Compliant, Lead Free**



**3D Image**

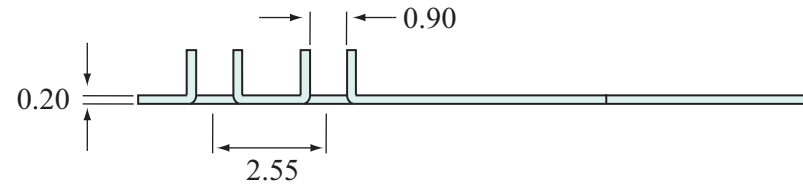
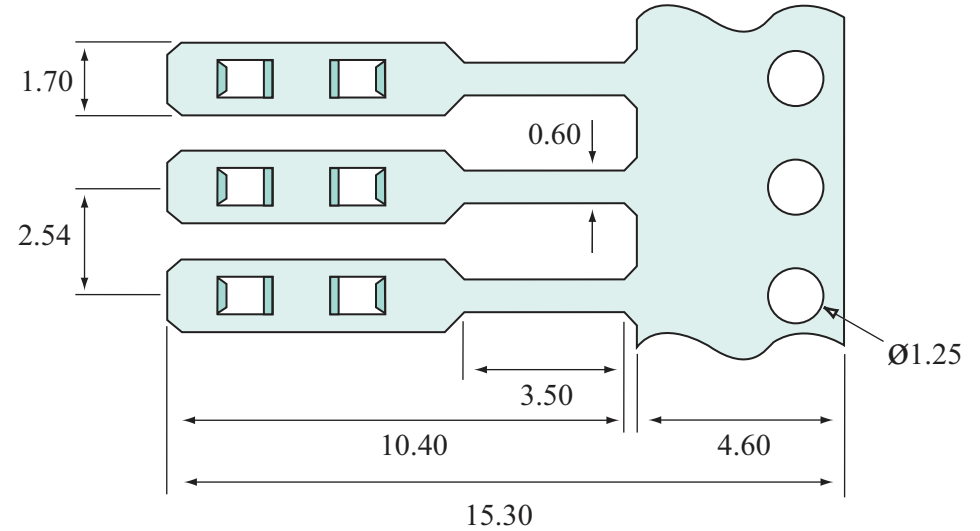
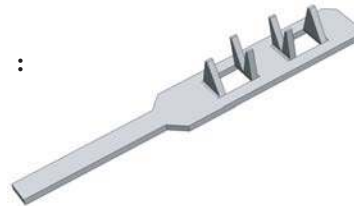

**MEMCON Limited**  
 Compass House Vision Park Chivers Way HISTON Cambridge CB24 9AD  
 United Kingdom T +44 1223 257724 F +44 1223 257800  
 www.memcon.eu sales@memcon.eu

General Tolerance : ±0.02 Unit : mm

<b>PART NO:</b> <b>MLST241-T35</b>	<b>DRAWING NO:</b>	<b>REV</b>	<b>DATE</b>	<b>DRAWN</b>	<b>CHECKED</b>	<b>APPROVED</b>	<b>CUSTOMER IF APPLICABLE</b>
		<b>B</b>	04/02/08	ER	AB	PC	
<b>DESCRIPTION:</b> <b>Long Male Solder Tab</b>	This document and drawings contains proprietary information which are the property of the Company and shall not be employed, copied, reprinted or disclosed to a third party in any manner, either wholly or in part, without the prior written consent of the Company						<b>DO NOT SCALE DRAWING DIMENSIONS MM</b>