

**NEW**



# MPTBWS Series Single Row Thru Hole Walled Latching Pin Headers

4-50 Ways Available

Mates with MH545 Housings

Contact 0.40mm Square Pin

Temperature Range -40°C to +125°C

Insulation Resistance 1,000MΩ

Standard Gold Plated on Contact Area



Current Rating 2A AC

Withstanding Voltage 900VRMS

Voltage Rating 300VRMS

PA9T UL 94VO Black

RoHS Compliant **RoHS**

## Outline Dimension

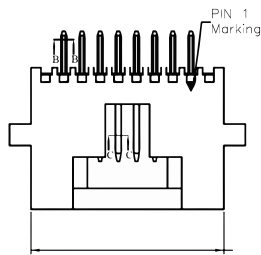

$1.27X(\text{No. of Ways}-1)+4.60$

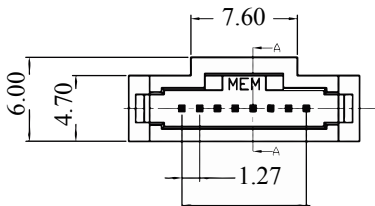
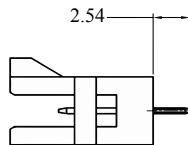

$1.27X(\text{No. of Ways}-1)$

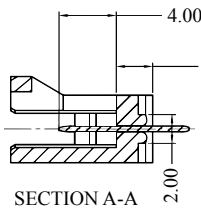

## Mating Connector



MH545

## Recommended PCB Layout

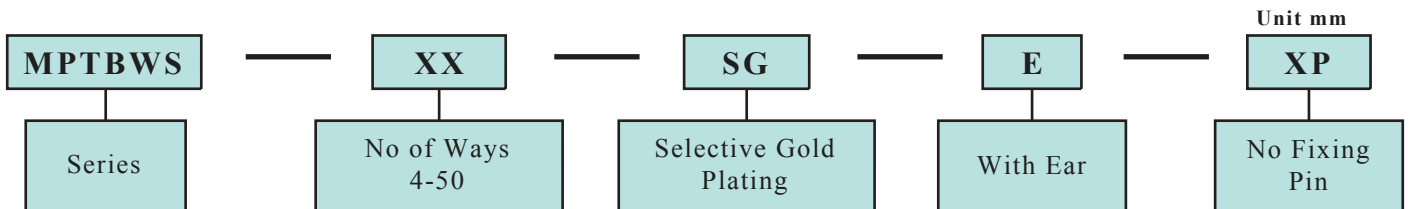
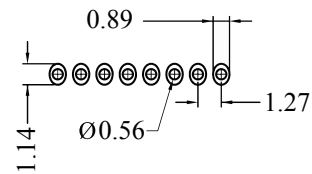

**MEMCON (Asia) Limited**  
 Units 5/6 6/F Westley Square  
 48 Hoi Yuen Rd Kwun Tong Hong Kong  
 T +852 3741 1411 F +852 3747 8980  
 www.memcon.asia sales@memcon.asia  
 GB Issue 1

**MEMCON Limited**  
 Unit 8 Campus Five Third Avenue Letchworth  
 Hertfordshire SG6 2JF United Kingdom  
 T +44 1462 371477 F +44 1462 677499  
 www.memcon.eu sales@memcon.eu  
 MEMCON<sup>®</sup> is a registered trade mark of Memcon Limited

**MEMCON North America**  
 6000 Red Arrow Hwy Unit  
 Stevensville Michigan 49127 USA  
 T +1 269 281 0478 F +1 269 593 5952  
 www.memcon.net sales@memcon.net