

Polarized & Locking Housing

MHE Series

Designed for use on Membrane Switches, Flexible Circuits, Jumper Cables, Sensors, Textile Ribbons etc

Mates with Industry Standard 0.635mm Walled Pin Headers

Suitable for use with Female Contacts

2.54mm Pitch

UL 94V-O Classified

Thermoplastic with Glass Fibre

Contact your Local Office for Application/ Crimping Equipment

Non Polarized and Latching Variations also Available

RoHS Compliant

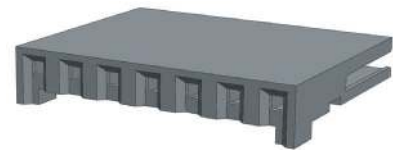
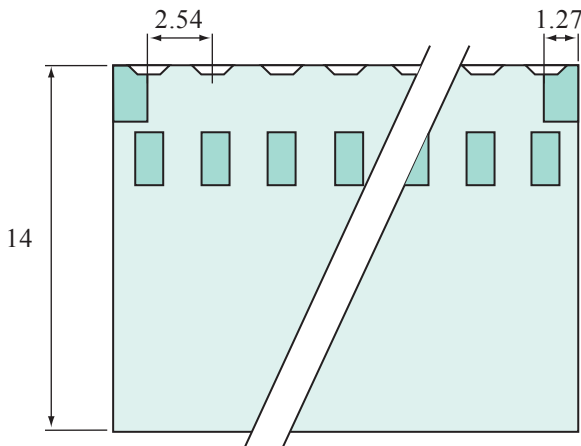
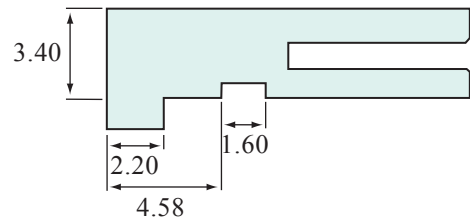
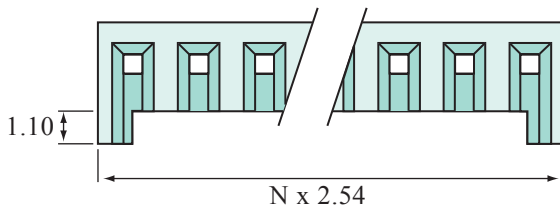

Unit : mm

