

Low Insertion Force Female Solder Contact



Designed for Soldering directly to
Flexible PCB or Ultra Thin Rigged PCBs

Tin Plating as Standard,
Others Available Upon Request

2.54mm Pitch

Phosphor Bronze Contact

RoHS Compliant, Lead Free

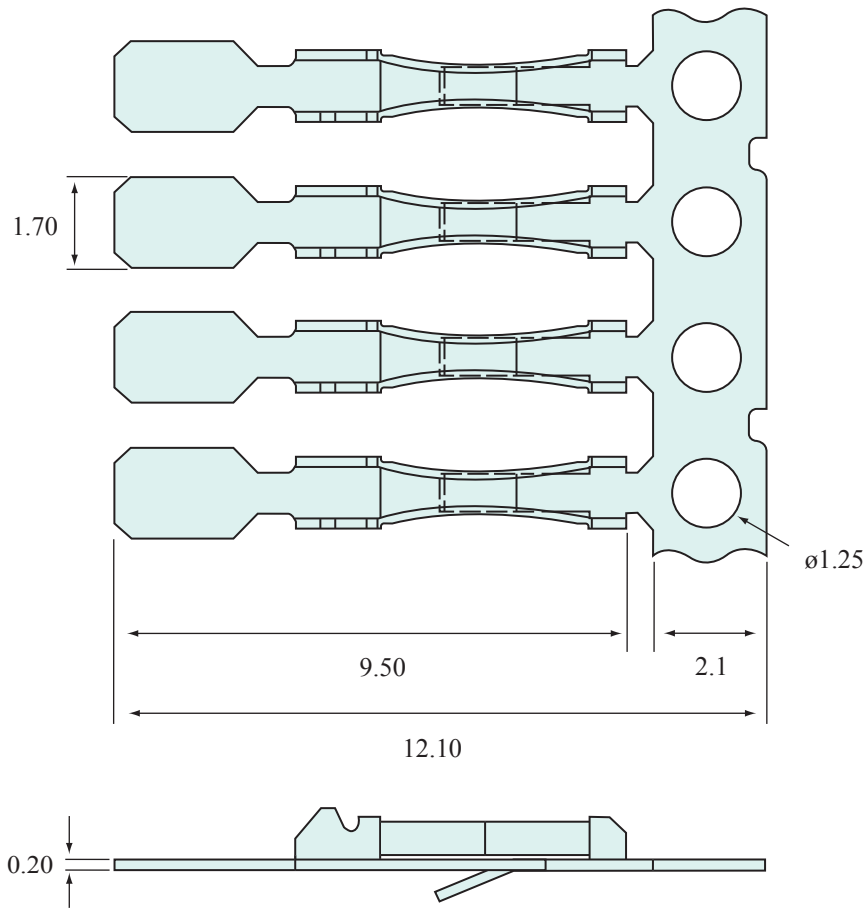

Unit : mm

Part Number	Description	Plating	Reel Quantity
MLFFSC506-T35	Low Force Female Solder	Tin	35,000
OTHER PLATING AND REEL SIZES AVAILABLE ON REQUEST			