

### Technical Characteristics

- Material** : Phosphor Bronze
- Contact Resistance** : 10 mΩ Max
- Insulation Resistance** : 5.10<sup>5</sup> MΩ at 500V
- Withstanding Voltage** : 1100V
- Contact Direct Current Rating** : 3A DC
- Contact Alternating Current Rating** : 5A AC
- Operating Temperature** : -55°C to +150°C
- Capacitance between Two Contacts** : 4pF Max

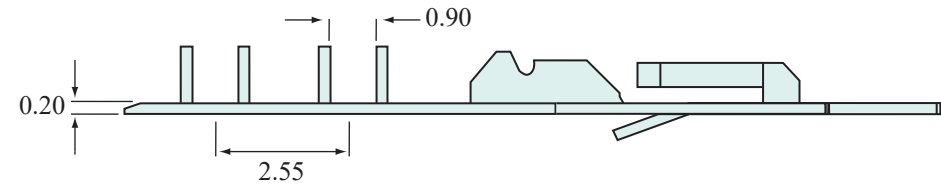
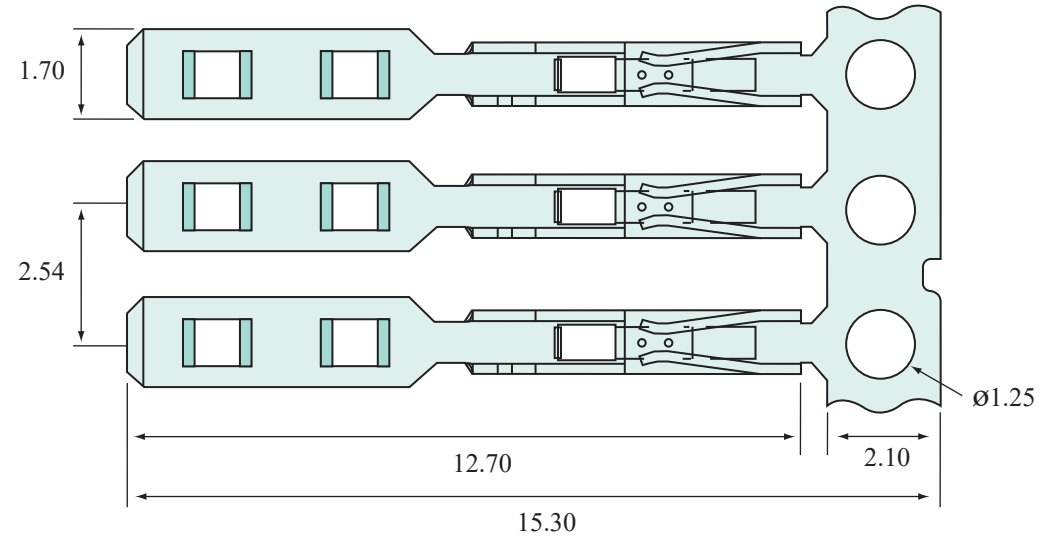

**MEMCON Limited**  
 Unit 8 Campus Five Third Avenue Letchworth Hertfordshire SG6 2JF  
 United Kingdom T +44 (0)1462 371477 F +44 (0)1462 677499  
 www.memcon.eu sales@memcon.eu

General Tolerance : +/- 0.20 Unit : mm

**PART NO:** **MHFFC106-XXX**

<b>DRAWING NO:</b>	<b>REV</b>	<b>DATE</b>	<b>DRAWN</b>	<b>CHECKED</b>	<b>APPROVED</b>	<b>CUSTOMER IF APPLICABLE</b>
	F	21/10/14	ER	AB	PC	

**DESCRIPTION:**  
**High Flex Female Contact**

This document and drawings contains proprietary information which are the property of the Company and shall not be employed, copied, reprinted or disclosed to a third party in any manner, either wholly or in part, without the prior written consent of the Company

**DO NOT SCALE DRAWING DIMENSIONS MM**

## Mechanical Characteristics

### Plating Options

- Tin (T)** : 2.5 $\mu$  Tin over 1.25 $\mu$  Nickel
- Selective Gold (SG)** : 0.15 $\mu$  Gold over 1.25 $\mu$  Nickel
- Others Available Upon Request**

### Crimp Strength to Flat Copper Cable

- Parallel to the Tracks** : 50N Min
- Perpendicular to the Tracks** : 15N Min

### RoHS Compliant, Lead Free



### 3D Image

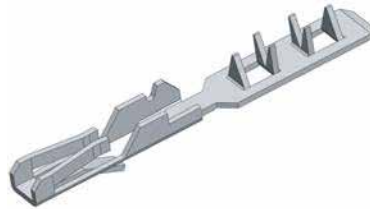

**MEMCON Limited**  
 Unit 8 Campus Five Third Avenue Letchworth Hertfordshire SG6 2JF  
 United Kingdom T +44 (0)1462 371477 F +44 (0)1462 677499  
[www.memcon.eu](http://www.memcon.eu) [sales@memcon.eu](mailto:sales@memcon.eu)

General Tolerance : +/- 0.20 Unit : mm

**PART NO:**  
**MHFFC106-XXX**

<b>DRAWING NO:</b>	<b>REV</b>	<b>DATE</b>	<b>DRAWN</b>	<b>CHECKED</b>	<b>APPROVED</b>	<b>CUSTOMER IF APPLICABLE</b>
	<b>F</b>	21/10/14	ER	AB	PC	

**DESCRIPTION:**  
**High Flex Female Contact**

This document and drawings contains proprietary information which are the property of the Company and shall not be employed, copied, reprinted or disclosed to a third party in any manner, either wholly or in part, without the prior written consent of the Company

**DO NOT SCALE DRAWING DIMENSIONS MM**