

# Polarized & Locking Housing MHL Series

Designed for use on Membrane  
Switches, Flexible Circuits, Jumper  
Cables, Sensors, Textile Ribbons etc

Mates with Industry Standard  
0.635mm Walled Pin Headers

Suitable for use with Female Contacts

2.54mm Pitch

UL 94V-O Classified

Thermoplastic with Glass Fibre

Contact your Local Office for Application/  
Crimping Equipment

Non Polarized and Non Latching Variations  
also Available

RoHS Compliant

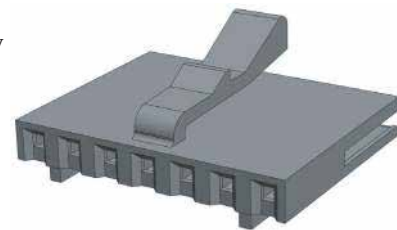
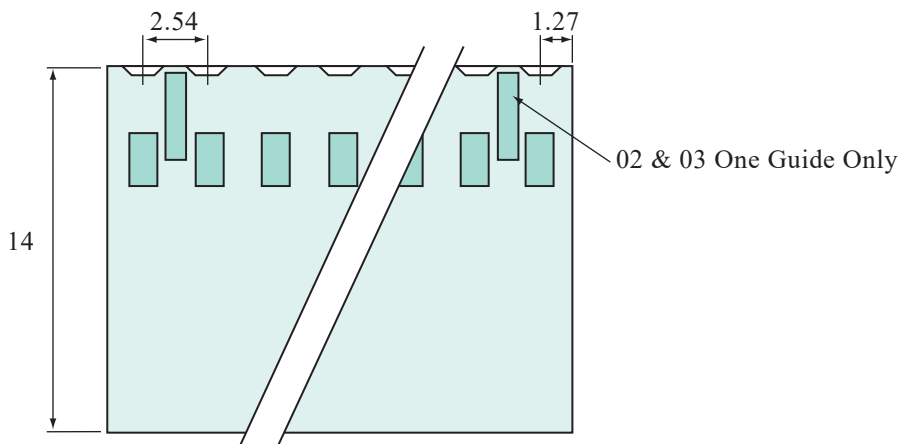
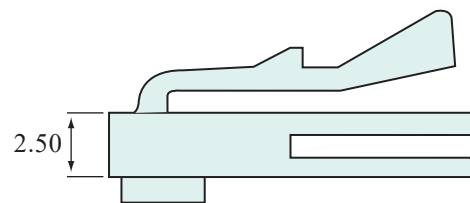
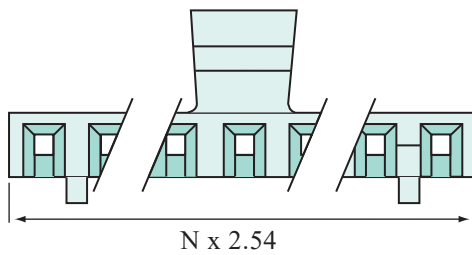

Unit : mm

**MHL**  
Series

— **XX**  
No of Ways (2-25)