

Technical Characteristics

Material : Thermoplastic with Glass Fibre
Classified : UL94VO
Colour : Black as Standard
 : Other Colours Available Upon Request
Number of Ways : 1-30 Ways
Pitch : 2.54mm
Recommended Contact : MHFFC106

RoHS Compliant, Lead Free :



3D Image :

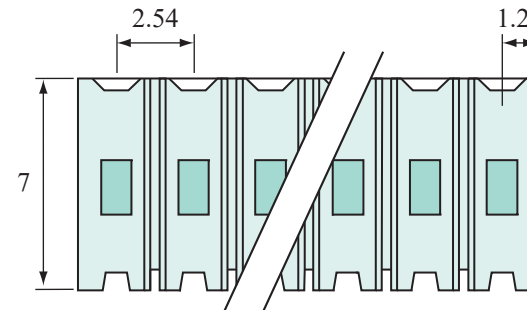
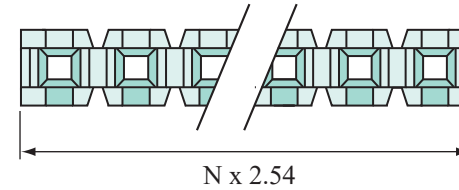
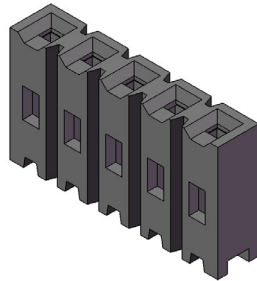

 **MEMCON Limited**
 Unit 8 Campus Five Third Avenue Letchworth Hertfordshire SG6 2JF
 United Kingdom T +44 (0)1462 371477 F +44 (0)1462 677499
www.memcon.eu sales@memcon.eu

General Tolerance : +/- 0.20 Unit : mm

PART NO: **MH7F-XX**

DRAWING NO:	REV	DATE	DRAWN	CHECKED	APPROVED	CUSTOMER IF APPLICABLE
	A	14//11/23	EW	JC	CL	

DESCRIPTION: **Low Profile Housings**

This document and drawings contains proprietary information which are the property of the Company and shall not be employed, copied, reprinted or disclosed to a third party in any manner, either wholly or in part, without the prior written consent of the Company

DO NOT SCALE DRAWING DIMENSIONS MM